

INSTRUCTIONS AND ASSEMBLY



Eurotech group, info@eurotechgroup.com.au
For assistance call 1800 30 6161

INSTRUCTION AND ASSEMBLY

1. Slide media into top frame piece.

2. Attach the bottom frame piece, insert media material.

 3. Grommet screws can be changed for exterior or interior corners,

Expose the channel of the corner bracket in the correct position.

4. Insert and tighten bracket in place. Expose bracket channel in correct position.

5. Unscrew grommet screws with allen key and flip grommet screws for corners at the bottom frame piece & tighten.

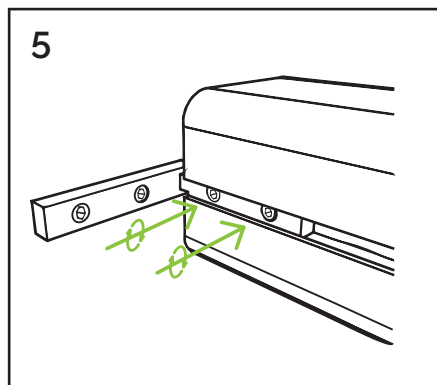
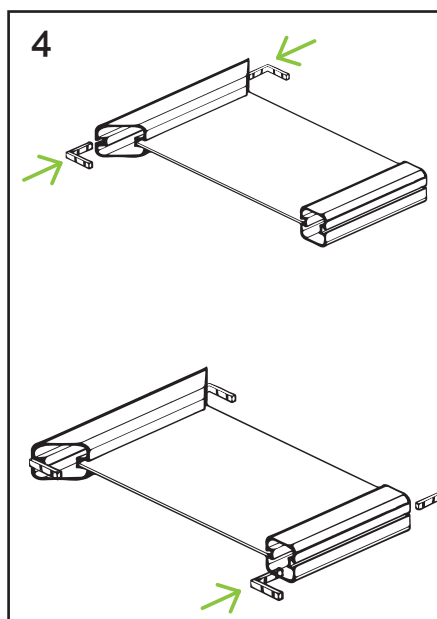
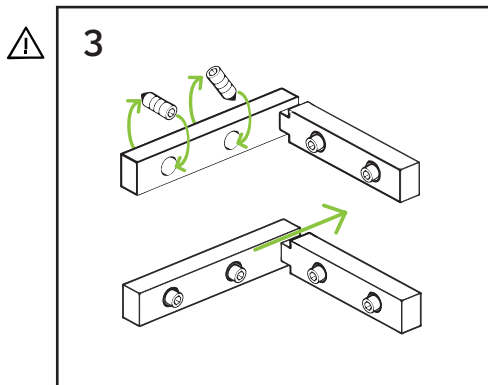
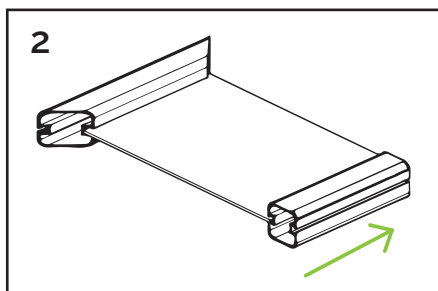
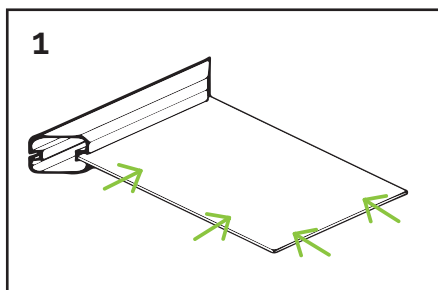

- 6.** Slide Visirite side frame pieces keeping corner brackets within the channel.

Apply pressure or stretch media to ensure it is firm & flat.

- 7.** Secure all grommet screws with allen key at the frame mitred join and inside corner.

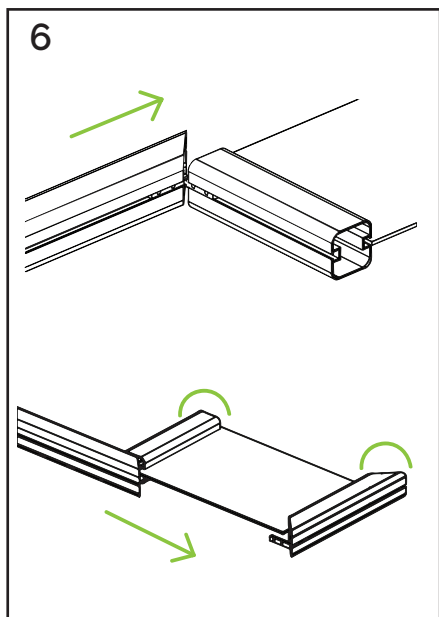

- 8.** Framed media can now be mounted with a hard surface mount, star picket, a Visirite Flat Foot or wall mount.

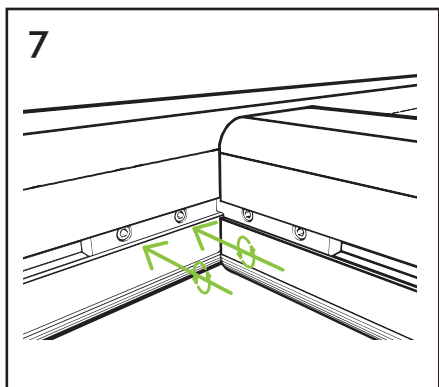
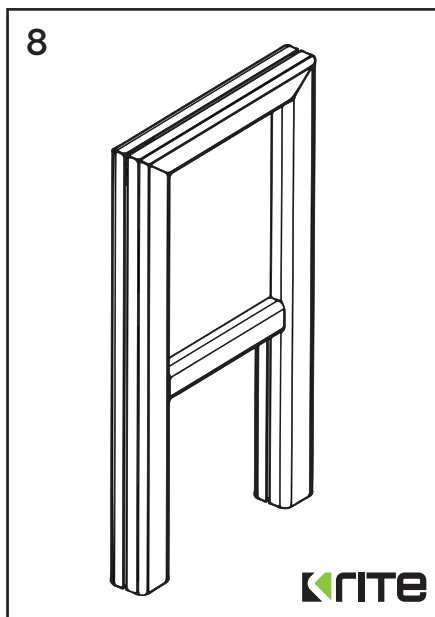

Frame overall size =
(insert panel size + 80mm)
e.g. 2080mm by 1080mm

Insert panel size & crop =
(frame overall size - 80mm)
e.g. 2000mm by 1000mm

Visible dimensions =
(overall size - 110mm)
e.g. 1970mm by 970mm

Crossbar Length =
(overall size - 110mm)
e.g. length of 1970mm

*Leg height for standing frame
minimum of 80mm.

45 degree
mitre

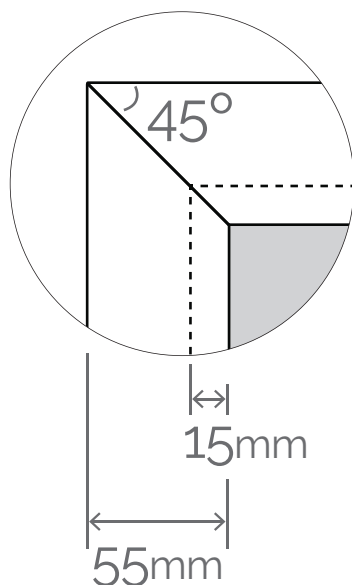

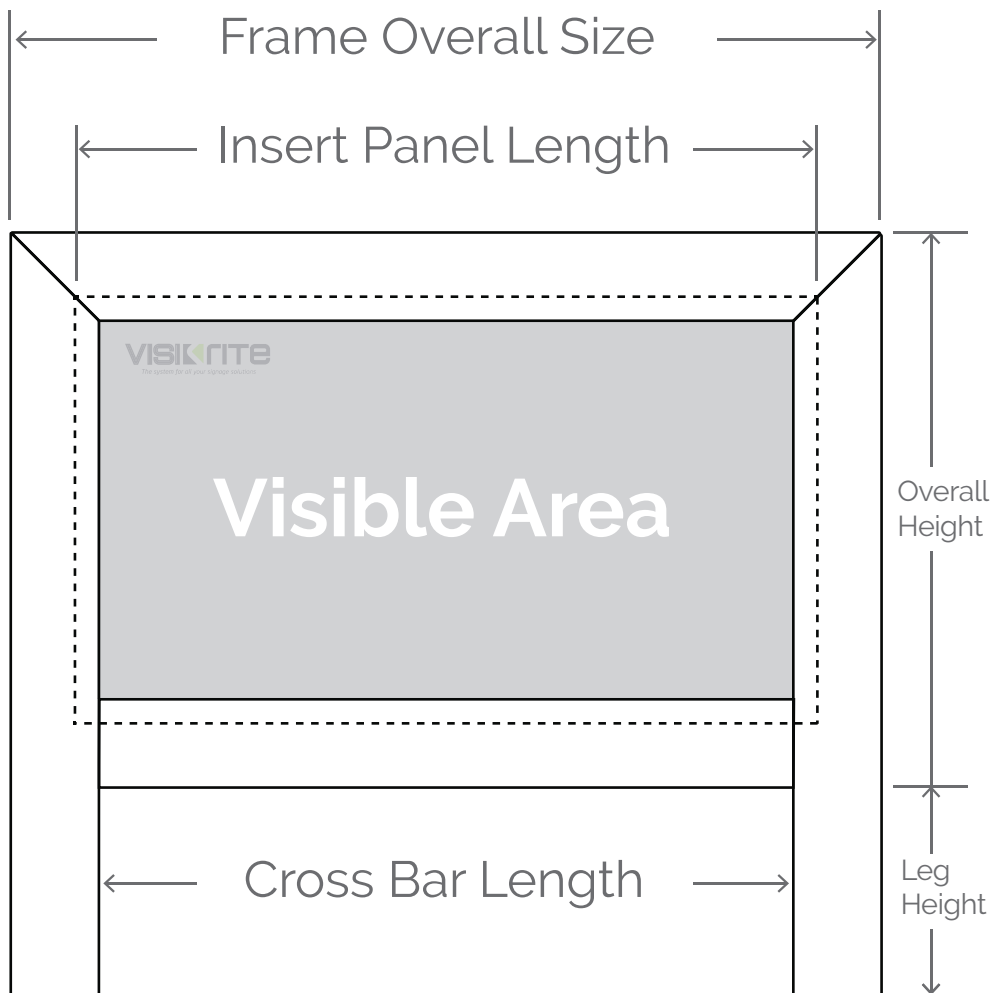

Artwork Template setup

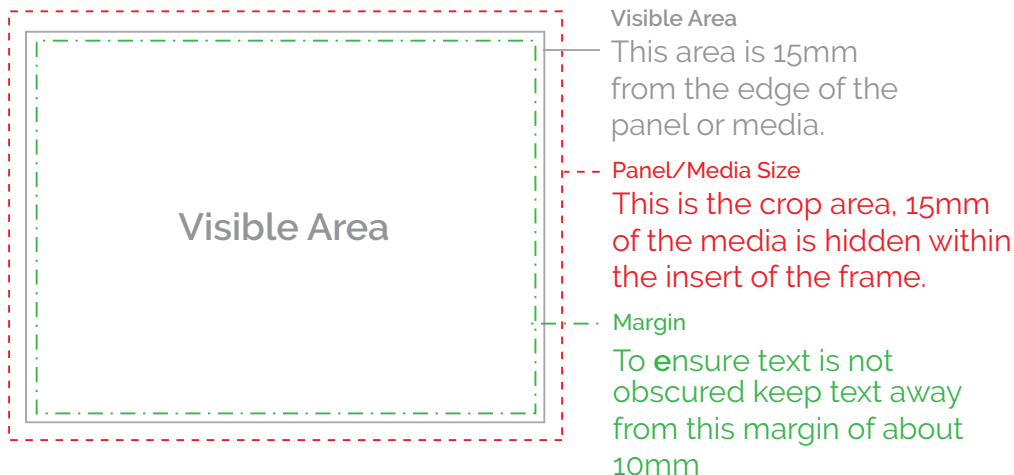

Notes
